



24 Dean Close
Portslade, BN41 2FS

Pearson
Keehan



Pearson
Keehan



Pearson
Keehan



Pearson
Keehan



Pearson
Keehan



Pearson
Keehan



Pearson
Keehan

24 Dean Close

Portslade, BN41 2FS

£1,575 Per month

PROPERTY OFFERED AS PART FURNISHED OR UNFURNISHED.

A very well-presented, terraced, family home situated in a highly sought-after location. This property offers fantastic far-reaching views and is perfect for families and commuters alike.

Entering in, you will discover a good sized living room offering a comfortable space for relaxation. The living room leads through to the kitchen, spacious and well-equipped with appliances, perfect for family meals and entertaining. Positioned at the rear is a conservatory, offering space to dine, with lovely views of the garden.

Upstairs, three bedrooms can be found, two double rooms and one single room/study. Additionally, there is a contemporary and stylish family bathroom, equipped with modern fixtures and fittings.

Outside, the rear garden is beautifully arranged over three tiers with the top level being a decked area offering stunning far-reaching views, along with gated rear access.

The property is situated in a prime location and is very popular with families due to its close proximity to well-esteemed schools, parks, local shops and bus routes. Portslade station is also just a short distance away, along with the A27, making it an excellent choice for commuters as well.

The property is available for occupation from mid October.

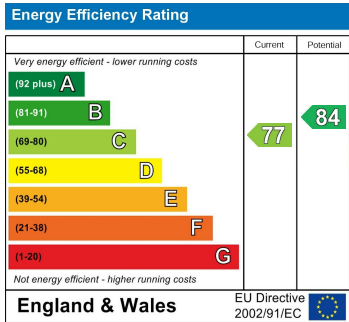
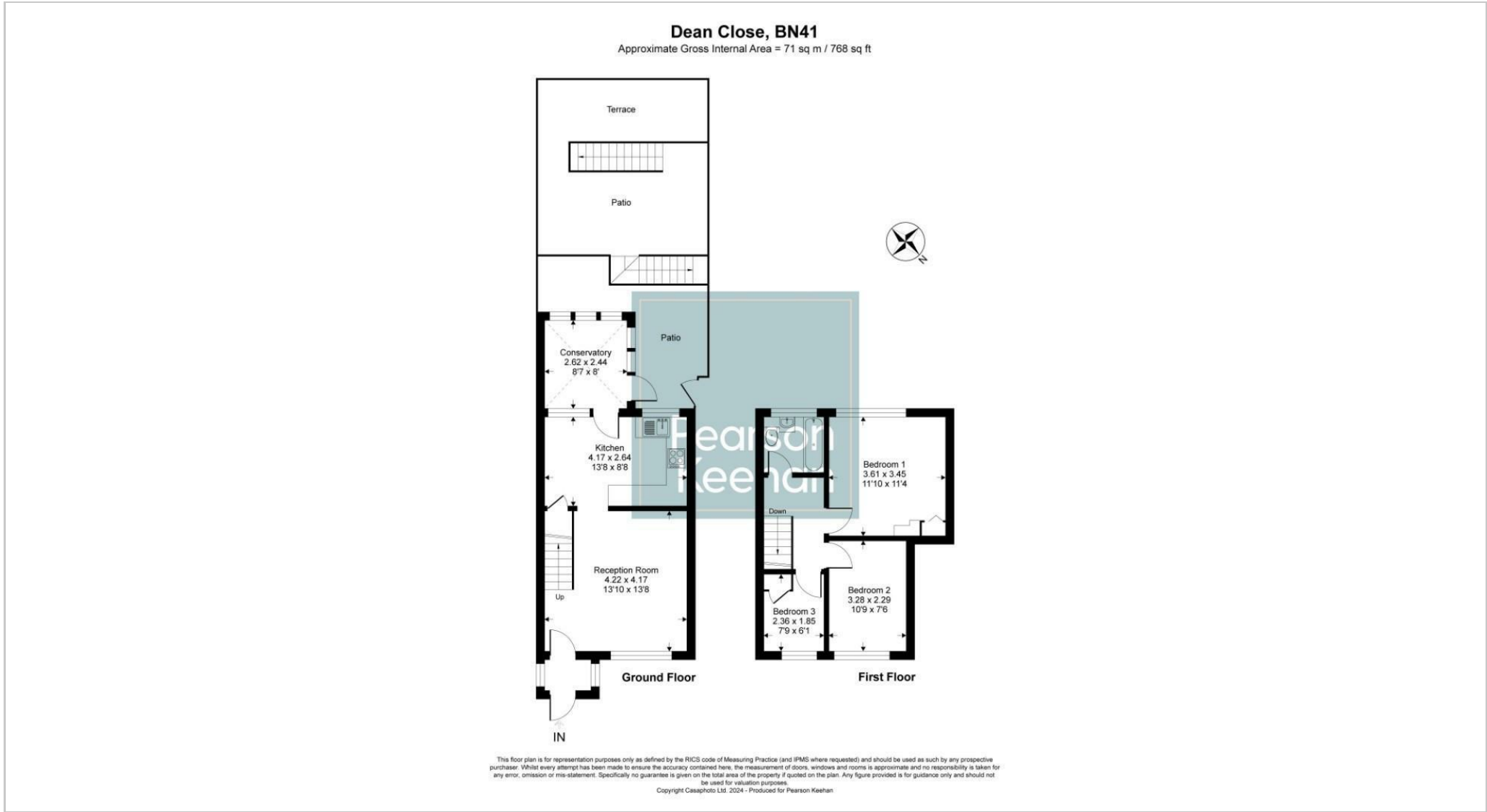

Pearson
Keehan